

NOTES:

1. MATERIAL:SEE BOM
2. FINISH: N/A
3. PART IS TO BE CLEAN AND FREE OF GREASE, DIRT, OIL, AND ALL OTHER CONTAMINANTS.
4. DRAWING SHOWN WITH OPTIONAL MOUNTING FEET AND HARDWARE.

| REVISIONS | | | |
|-----------|-----------------|-----------|----------|
| REV. | DESCRIPTION | DATE | APPROVED |
| A | INITIAL RELEASE | 7/21/2009 | RNA |

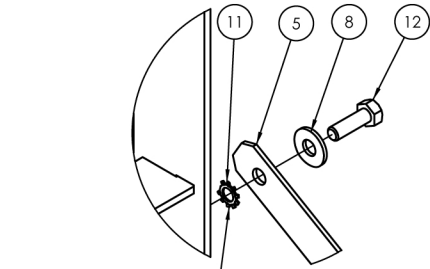

NOTICE STAR WASHER BETWEEN UPRIGHT AND CROSS BRACE

DETAIL A
SCALE 1 : 2

BATTERIES SHOWN FOR REFERENCE ONLY. SOLD SEPARATELY.

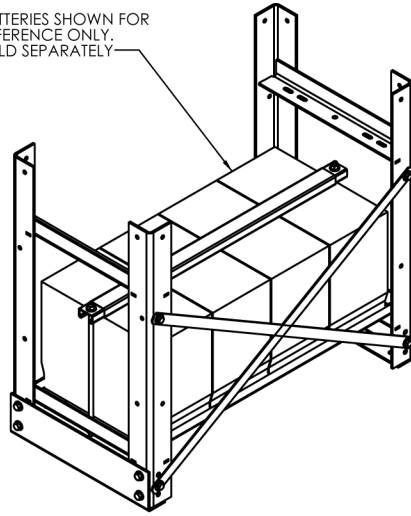

REAR ISO VIEW

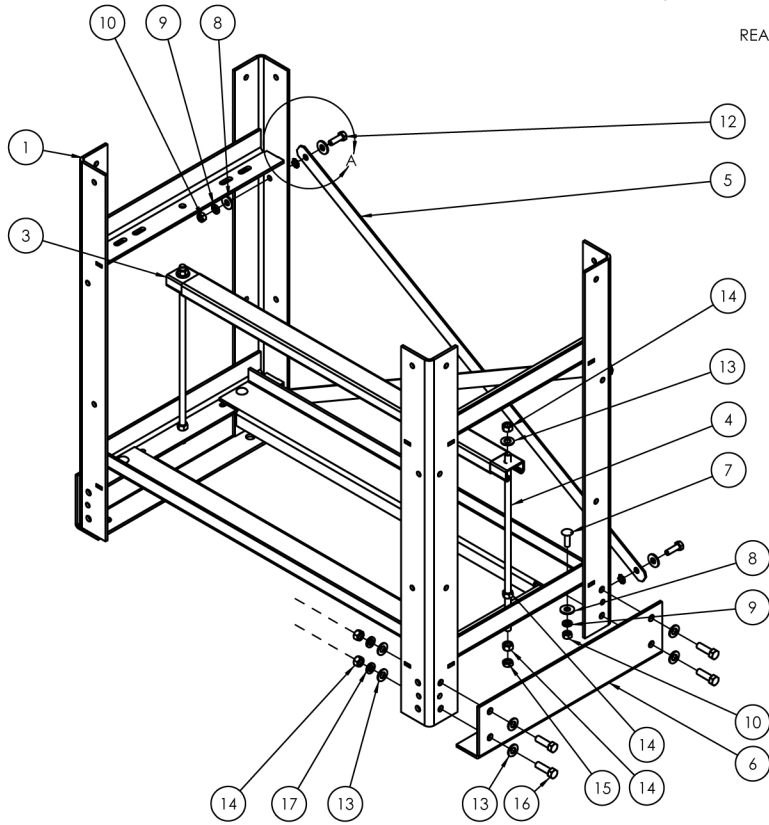
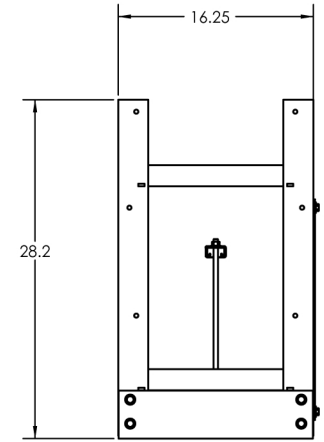
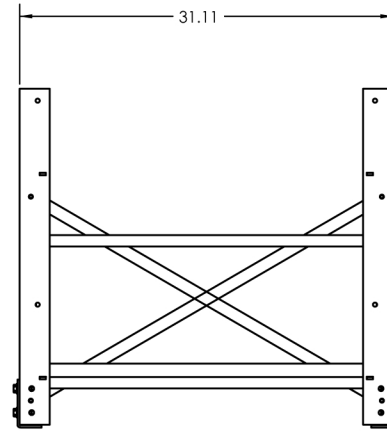

FRONT ISO VIEW

| ITEM NO. | PART NUMBER | DESCRIPTION | Default/ QTY |
|----------|----------------------------|--|--------------|
| 17 | SPLITLOCKWASHER3/8ZINC | 3/8" LOCK WASHER, Z.P. | 8 |
| 16 | HEXBOLT3/8-16X1-1/4ZINC | HBOLT 0.3750-16x1-1/4", Z.P. | 8 |
| 15 | HEXJAMNUT3/8-16ZINC | HEX JAM NUT, 3/8-16, ZINC | 2 |
| 14 | HEXNUT3/8-16ZINC | HEX NUT, 3/8-16, ZINC | 14 |
| 13 | FLATWASHER3/8ZINC | 3/8" FLAT WASHER, Z.P. | 18 |
| 12 | HEXBOLTS5/16-18X1ZINC | HEX BOLT, 5/16-18 X 1.0, ZINC | 4 |
| 11 | EXTTOOTHWASHER.312ZINC | EXTERNAL TOOTH WASHER, 5/16, ZINC | 4 |
| 10 | HEXNUTS5/16-18ZINC | NUT, HEX, 5/16-18 ZINC | 8 |
| 9 | SPLITLOCKWASHERS5/16ZINC | WASHER, SPLIT LOCK, 5/16 ZC | 8 |
| 8 | FLATWASHER3/8ZINC | WASHER, FLAT, .312, ZC | 12 |
| 7 | CARRIAGEBOLTS5/16-18X1ZINC | CARRIAGE BOLT, 5/16-18 X 1.0, ZC | 4 |
| 6 | BRC-000900 | FEET, BRACE, OPEN FRAME RACKS | 2 |
| 5 | BRC-000700 | CROSS BRACE, BATT. RACK, 4 WIDE | 2 |
| 4 | BRC-000500 | BRACE, BATT. HOLD DOWNS | 2 |
| 3 | RST-000702 | HOLD DOWN, BATT., 4-WD, WITH SHRINK, 30" | 1 |
| 2 | BTR-000202 | BATTERY RAIL, 4 WIDE, | 2 |
| 1 | FRM-006200 | FRAME, 1 TIER/2TIER | 2 |

| | | | | | |
|---|-------------|----------------------|---------------------------------|---|-----------|
| UNLESS OTHERWISE SPECIFIED: DIMENSIONS ARE IN INCHES TOLERANCES: ANGULAR: MACH ± .5 BEND ±1 TWO PLACE DECIMAL ±.01 THREE PLACE DECIMAL ±.005 | | | | TITLE: BATTERY RACK, 1 TIER/4 WIDE OPEN FRAME | |
| PROJECTION: CHECKED | NAME RNA | | | DATE 07-20-09 | SIZE C |
| MATERIAL: SEE NOTE 1 | ENG APPR. | MFG APPR. | SCALE: 1:8 WEIGHT: SHEET 1 OF 1 | | |
| FINISH: SEE NOTE 2 | G.A. | DO NOT SCALE DRAWING | USED ON | | |

PROPRIETARY AND CONFIDENTIAL
THE INFORMATION CONTAINED IN THIS DRAWING IS THE SOLE PROPERTY OF ELECTRONIC SYSTEMS SUPPORT. ANY REPRODUCTION IN PART OR AS A WHOLE WITHOUT THE WRITTEN PERMISSION OF ELECTRONIC SYSTEMS SUPPORT IS PROHIBITED.